

KQ5010



Capacitive sensor

KQ-3040NAPKG/0,04M/AS

Article no longer available - archive entry

Alternative articles: KQ5101

When selecting an alternative article and accessories please note that technical data may differ!

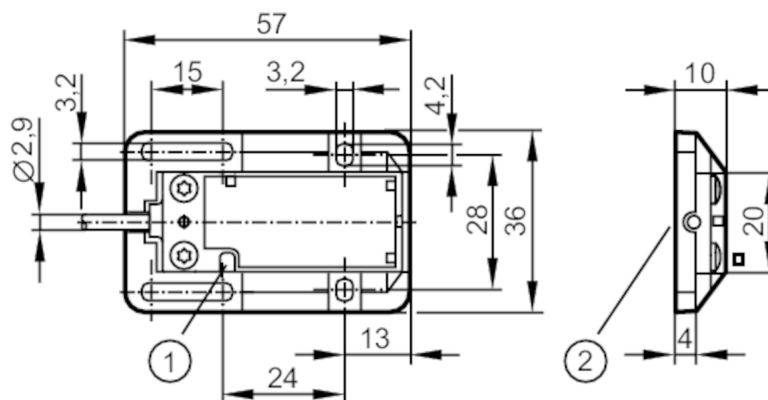

- 1 LED
- 2 Sensing face



Product characteristics

Electrical design	PNP
Output function	normally closed
Sensing range [mm]	8; (preset: 4,0 mm ($\pm 0,2$ mm))
Housing	rectangular
Dimensions [mm]	20 x 7 x 48

Electrical data

Operating voltage [V]	10...36 DC; ("supply class 2" according to UL)
Current consumption [mA]	< 17
Protection class	III
Reverse polarity protection	yes

Outputs

Electrical design	PNP
Output function	normally closed
Max. voltage drop switching output DC [V]	2.5
Permanent current rating of switching output DC [mA]	100
Switching frequency DC [Hz]	10
Short-circuit proof	yes
Overload protection	yes

Detection zone

Sensing range [mm]	8; (preset: 4,0 mm ($\pm 0,2$ mm))
Sensing range adjustable	yes
Factory setting sensing range [mm]	4

KQ5010



Capacitive sensor

KQ-3040NAPKG/0,04M/AS

Accuracy / deviations		
Correction factor		glass: 0.4 / water: 1 / ceramics: 0.2 / PVC: 0.2
Hysteresis	[% of Sr]	1...15
Switch point drift	[% of Sr]	-20...20
Operating conditions		
Ambient temperature		[°C] -25...80
Protection		IP 65; IP 67
Tests / approvals		
EMC		EN 60947-5-2
Mechanical data		
Weight		[g] 67.4
Housing		rectangular
Mounting		non-flush mountable
Dimensions		[mm] 20 x 7 x 48
Materials		PBT; TPE-U; stainless steel
Displays / operating elements		
Display		switching status 1 x LED, yellow
Accessories		
Items supplied		mounting adapter: 1, fitted
Remarks		
Pack quantity		1 pcs.
Electrical connection - plug		
Cable: 0.045 m, PUR		
Connector: 1 x M8; coding: A		



Connection

