

## Process adapter hygienic pipe fitting

ADAPT G3/4-DIN11851/DN40 (1.5)

Article no longer available - archive entry

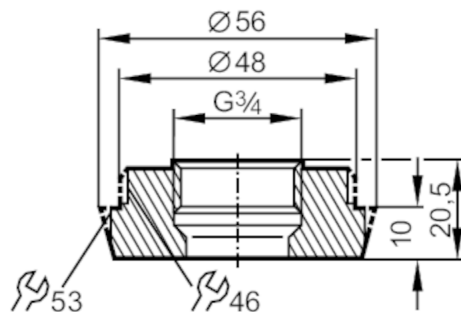

## Application

|                 |       |    |
|-----------------|-------|----|
| Pressure rating | [bar] | 40 |
|-----------------|-------|----|

## Tests / approvals

|                              |                                                                                                               |
|------------------------------|---------------------------------------------------------------------------------------------------------------|
| Pressure Equipment Directive | A possible classification to PED depends on the application and has to be carried out by the user / operator. |
| Safety instructions          | The compatibility between medium and product material has to be checked in all applications.                  |

## Mechanical data

|                                                   |                                             |
|---------------------------------------------------|---------------------------------------------|
| Materials                                         | stainless steel (316L/1.4435)               |
| Sensor connection                                 | G 3/4                                       |
| Process connection                                | hygienic pipe fitting DN40 (1,5") DIN 11851 |
| Surface characteristics Ra/Rz of the wetted parts | 0.4 / 4                                     |
| Hygienic equipment class to DIN 11866             | H4                                          |

## Remarks

|               |        |
|---------------|--------|
| Pack quantity | 1 pcs. |
|---------------|--------|