

## Flow sensor for connection to an evaluation unit

SFR12ABA/10M/PH

Article no longer available - archive entry

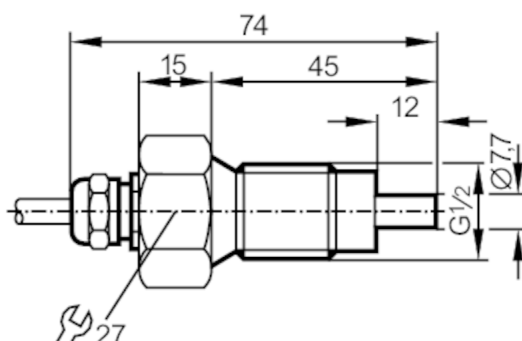

## Product characteristics

Process connection	G 1/2 external thread
--------------------	-----------------------

## Application

Application	high-temperature range
Media	Liquids; Gases
Medium temperature [°C]	-25...80
Pressure rating [bar]	30

## Liquids

Application	high-temperature range
Medium temperature [°C]	-25...80

## Gases

Medium temperature [°C]	-25...80
-------------------------	----------

## Electrical data

Connection to control monitor	VS 0200
-------------------------------	---------

## Measuring/setting range

## Liquids

Setting range [cm/s]	3...300
Greatest sensitivity [cm/s]	3...60

## Gases

Setting range [cm/s]	200...2000
Greatest sensitivity [cm/s]	200...800

## Accuracy / deviations

Temperature gradient [K/min]	15
------------------------------	----

## Response times

Response time [s]	1...10
-------------------	--------

## Liquids

Response time [s]	1...10
-------------------	--------

## Gases

Response time [s]	1...10
-------------------	--------

# SF3002



## Flow sensor for connection to an evaluation unit

SFR12ABA/10M/PH

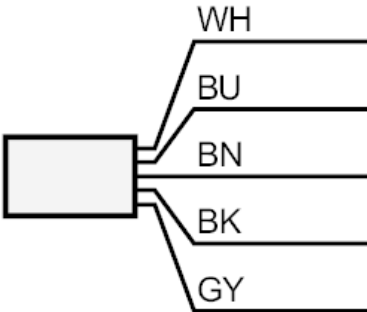
Operating conditions	
Protection	IP 67
Mechanical data	
Housing	threaded type
Materials	stainless steel (1.4305 / 303)
Materials (wetted parts)	stainless steel (1.4305 / 303)
Process connection	G 1/2 external thread
Accessories	
Items supplied	sealings: 2 x AMF 30
Remarks	
Pack quantity	1 pcs.
Electrical connection	
Cable: 10 m, PUR / PVC; 5 x 0.34 mm <sup>2</sup>	
Connection	
<div></div>	
<div><div>BN =</div><div>BU =</div><div>BK =</div><div>WH =</div><div>GY =</div><div>Core colours :</div><div>brown</div><div>blue</div><div>black</div><div>white</div><div>grey</div></div>	