

# E43016

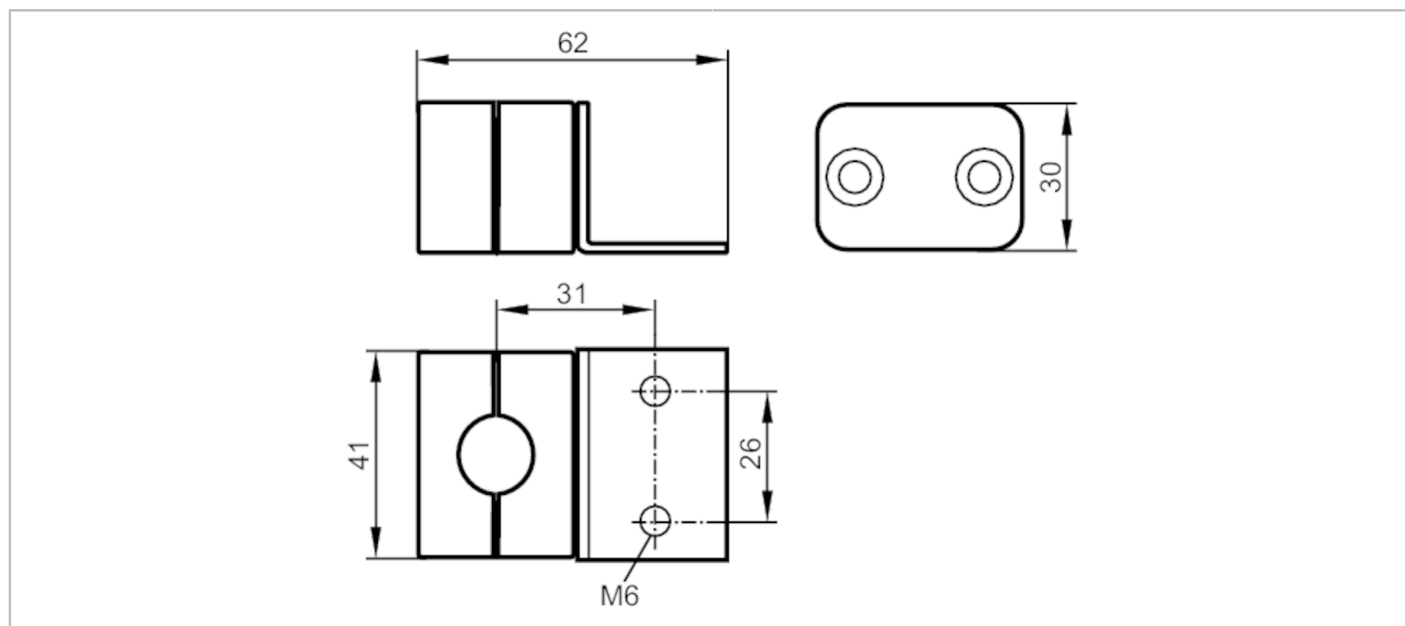

## Mounting clamp for level sensors

MOUNTING SET D16



Application	
Design	for capacitive level sensors LK, LI, LT, LL
Mechanical data	
Weight [g]	101.5
Dimensions [mm]	62 x 41 x 30
Inside diameter [mm]	16
Materials	PP; metal parts: steel galvanised
Tightening torque [Nm]	2.5
Remarks	
Pack quantity	1 pcs.