

RB6012



Incremental encoder with solid shaft

RB-0250-I24/L2

discontinued article

Alternative article: RB3500 When selecting an alternative article and accessories please note that technical data may differ! –
When selecting an alternative article and accessories please note that technical data may differ! – Discontinuation date: 31.03.2016

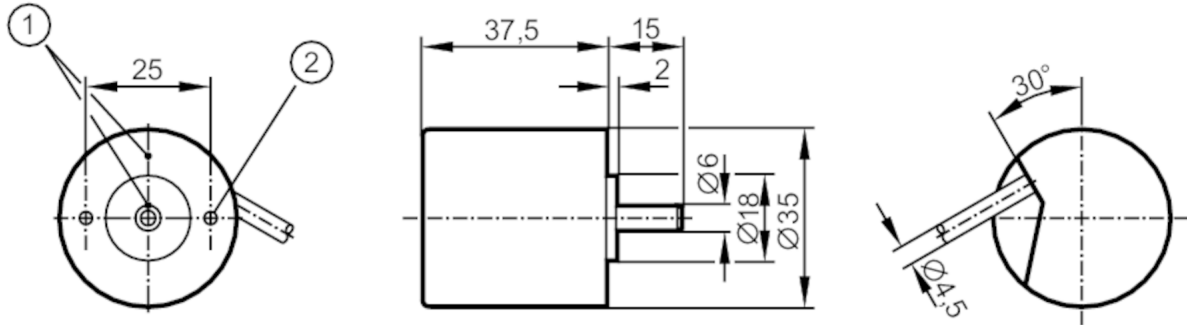

- 1 reference mark
- 2 M3 Depth 5 mm



Product characteristics	
Resolution	250 resolution
Shaft design	solid shaft
Shaft diameter [mm]	6
Application	
Function principle	incremental
Electrical data	
Operating voltage [V]	10...30 DC
Current consumption [mA]	150
Outputs	
Electrical design	HTL
Max. current load per output [mA]	50
Switching frequency [kHz]	160
Type of short-circuit protection	< 60 s
Phase difference A and B [°]	90
Measuring/setting range	
Resolution	250 resolution
Operating conditions	
Ambient temperature [°C]	-40...70
Note on ambient temperature	for firmly laid cable
Max. relative air humidity [%]	75; (briefly: 95 %)
Protection	IP 64



Incremental encoder with solid shaft

RB-0250-I24/L2

Tests / approvals		
Shock resistance		100 g (6 ms)
Vibration resistance		10 g (55...2000 Hz)
MTTF	[years]	190
Mechanical data		
Weight	[g]	261.4
Dimensions	[mm]	Ø 35 / L = 52.5
Materials		aluminium
Max. revolution, mechanical	[U/min]	10000
Max. starting torque	[Nm]	1
Reference temperature torque	[°C]	20
Shaft design		solid shaft
Shaft diameter	[mm]	6
Shaft material		steel (1.4104)
Max. shaft load axial (at the shaft end)	[N]	5
Max. shaft load radial (at the shaft end)	[N]	10
Remarks		
Notes		discontinued article
Electrical connection		
Cable: 2 m, PUR; radial, can also be used axially		
brown	A	
green	0 V A	
grey	B	
pink	0 V B	
red	0 index	
black	0 V 0 index	
brown/green	L+ (Up)	
white/green	L- 0 V (Un)	
lilac	failure inverted	
screen	housing	
Diagrams and graphs		
Pulse diagram	<p>Output A Output B 0 index</p>	

discontinued article

RB6012

Incremental encoder with solid shaft

RB-0250-I24/L2



Alternative article: RB3500 When selecting an alternative article and accessories please note that technical data may differ! –
When selecting an alternative article and accessories please note that technical data may differ! – Discontinuation date: 31.03.2016