

Flow sensor for connection to an evaluation unit

SFR12ABB/US

Article no longer available - archive entry

Alternative articles: SF6200 + E40160

When selecting an alternative article and accessories please note that technical data may differ!

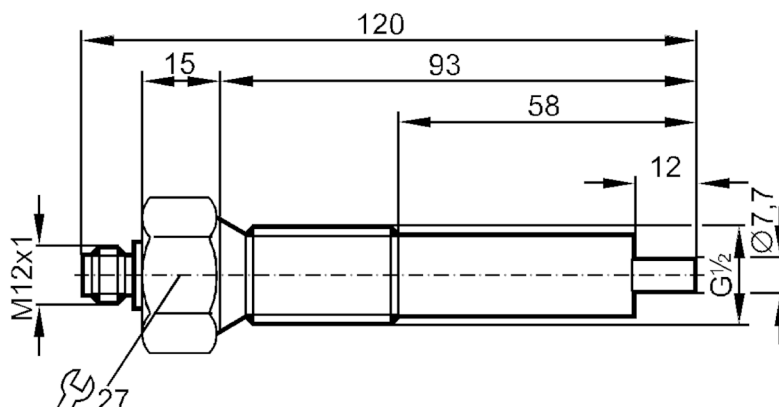

Product characteristics

Process connection	G 1/2 external thread
--------------------	-----------------------

Application

Application	high-temperature range
Media	Liquids; Gases
Medium temperature [°C]	-25...80
Pressure rating [bar]	30

Liquids

Application	high-temperature range
Medium temperature [°C]	-25...80

Gases

Medium temperature [°C]	-25...80
-------------------------	----------

Electrical data

Connection to control monitor	VS 0200
-------------------------------	---------

Measuring/setting range

Liquids

Setting range [cm/s]	3...300
Greatest sensitivity [cm/s]	3...60

Gases

Setting range [cm/s]	200...2000
Greatest sensitivity [cm/s]	200...800



Flow sensor for connection to an evaluation unit

SFR12ABB/US

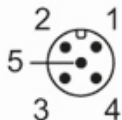
Accuracy / deviations		
Temperature gradient	[K/min]	15
Response times		
Response time	[s]	1...10
Liquids		
Response time	[s]	1...10
Gases		
Response time	[s]	1...10
Operating conditions		
Protection		IP 67
Mechanical data		
Housing		threaded type
Materials		stainless steel (1.4571/316Ti)
Materials (wetted parts)		stainless steel (1.4571/316Ti)
Process connection		G 1/2 external thread
Accessories		
Items supplied		sealings: 2 x AMF 30
Remarks		
Pack quantity		1 pcs.
Electrical connection		
Connector: 1 x M12; coding: A; Maximum cable length: 100 m		
		

SF0515



Flow sensor for connection to an evaluation unit

SFR12ABB/US

Connection

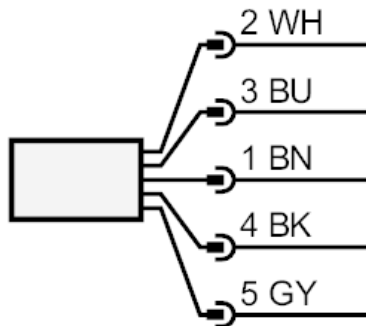

BN =	Core colours :	brown
BU =		blue
BK =		black
WH =		white
GY =		grey