

SF3408



Flow sensor for connection to an evaluation unit

SFN12AAC/US-100

Article no longer available - archive entry

Alternative articles: SF5700 + E40127

When selecting an alternative article and accessories please note that technical data may differ!

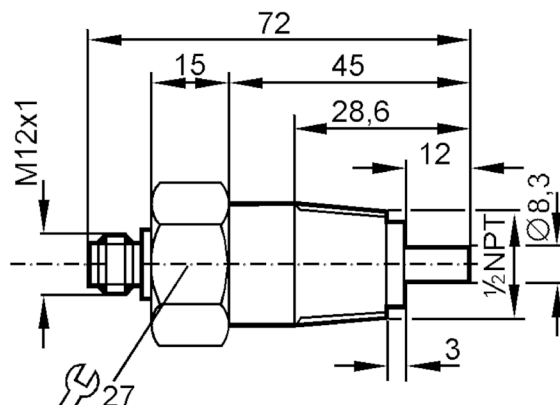

Product characteristics

Process connection 1/2" NPT

Application

Media Liquids; aggressive media

Medium temperature [°C] -25...80

Pressure rating [bar] 5

Liquids

Medium temperature [°C] -25...80

Electrical data

Connection to control monitor VS 0200

Measuring/setting range

Liquids

Setting range [cm/s] 0...60

Greatest sensitivity [cm/s] 0...20

Accuracy / deviations

Temperature gradient [K/min] 7

Response times

Response time [s] 2...20

Liquids

Response time [s] 2...20

SF3408



Flow sensor for connection to an evaluation unit

SFN12AAC/US-100

Operating conditions		
Protection	IP 67	
Tests / approvals		
Shock resistance	DIN IEC 68-2-27	40 g (11 ms)
Vibration resistance	DIN IEC 68-2-6	10 g (55...2000 Hz)
Mechanical data		
Housing	threaded type	
Materials	PTFE	
Materials (wetted parts)	PTFE	
Process connection	1/2" NPT	
Remarks		
Pack quantity	1 pcs.	

Electrical connection

Connector: 1 x M12; coding: A; Maximum cable length: 100 m

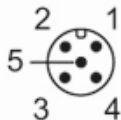

Connection

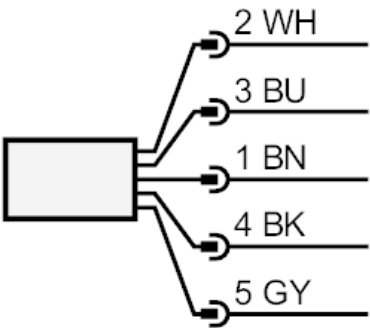

Core colours :	
BN =	brown
BU =	blue
BK =	black
WH =	white
GY =	grey