

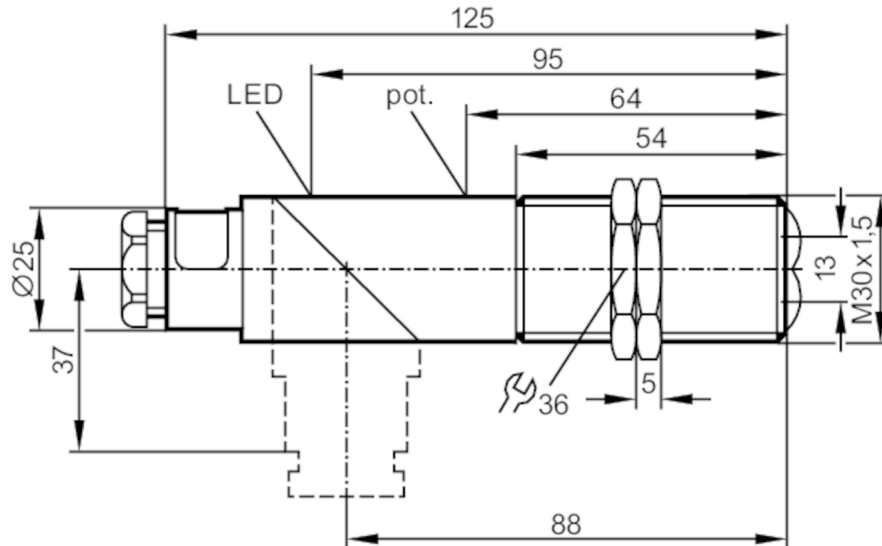

Diffuse reflection sensor

OIT-FBOW

Article no longer available - archive entry



Product characteristics

Housing		threaded type
Dimensions	[mm]	M30 x 1.5 / L = 125

Application

Function principle		Diffuse reflection sensor
--------------------	--	---------------------------

Electrical data

Frequency AC	[Hz]	47...63
Operating voltage	[V]	20...250 AC
Reverse polarity protection		no

Outputs

Output function		light-on/dark-on mode; (programmable)
Max. voltage drop switching output AC	[V]	4
Max. leakage current	[mA]	12
Permanent current rating of switching output AC	[mA]	300
Short-time current rating of switching output	[mA]	2200; (10 ms / 0,5 Hz)
Switching frequency AC	[Hz]	15
Short-circuit proof		no
Overload protection		no



Diffuse reflection sensor

OIT-FBOW

Detection zone		
Range	[mm]	3...700; (white paper 200 x 200 mm)
Range adjustable		yes
Max. light spot diameter	[mm]	122
Light spot dimensions refer to		at maximum range
Operating conditions		
Ambient temperature	[°C]	-25...60
Protection		IP 65
Tests / approvals		
EMC		EN 60947-5-2
MTTF	[years]	304
Mechanical data		
Weight	[g]	128
Housing		threaded type
Dimensions	[mm]	M30 x 1.5 / L = 125
Thread designation		M30 x 1.5
Materials		PBT; PPO modified
Lens material		PMMA
Displays / operating elements		
Display		switching status 1 x LED, yellow
Electrical connection		
Required protection		miniature fuse to IEC60127-2 sheet 1; ≤ 2 A; fast acting
Accessories		
Items supplied		lock nuts: 2 x screwdrivers
Remarks		
Remarks		Recommendation: Check the safe functioning of the unit after a short circuit.
Pack quantity		1 pcs.



Diffuse reflection sensor

OIT-FBOW

Electrical connection

terminals: ...1.5 mm²; Cable sheath: Ø 7...13 mm; Cable gland: M20 X 1.5

Connection

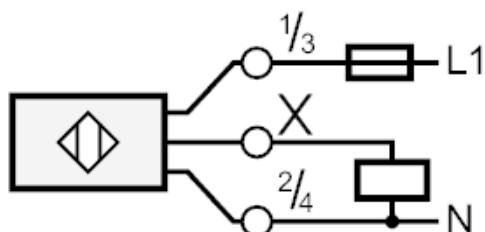

Note : miniature fuse to IEC60127-2 sheet 1 ≤ 2 A fast acting

Diagrams and graphs

excess gain graph

