

## Through-beam sensor transmitter

O6S-OOKG/0,30m/US

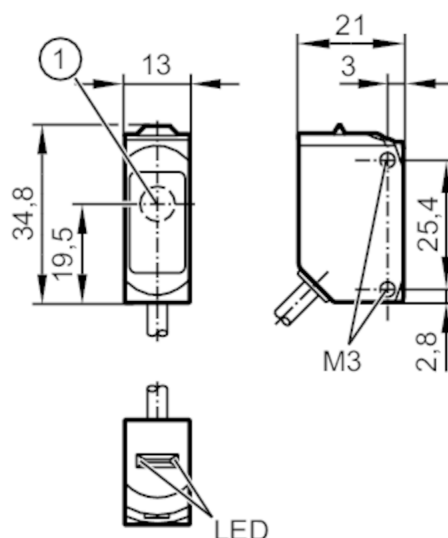

1: light emission



## Product characteristics

Type of light	red light
Housing	rectangular

## Application

Function principle	Through-beam sensor
Application	suited for use in the machine tool industry

## Electrical data

Operating voltage	[V]	10...30 DC
Current consumption	[mA]	11; ((24 V))
Protection class		III
Type of light		red light
Wave length	[nm]	633

## Detection zone

Transmitter / receiver	transmitter
Range [m]	< 10
Max. light spot diameter [mm]	300
Light spot dimensions refer to	at maximum range

## Operating conditions

Ambient temperature	[°C]	-25...60
Protection		IP 65; IP 67; IP 68

## Tests / approvals

EMC	EN 60947-5-2	
MTTF	[years]	2942
UL approval	UL Approval no.	E021

# O6S402



## Through-beam sensor transmitter

O6S-OOKG/0,30m/US

Mechanical data		
Weight	[g]	49.7
Housing		rectangular
Dimensions	[mm]	34.8 x 13 x 21
Materials		housing: stainless steel (316L/1.4404); plastics: PPSU; Sealing: FKM
Lens material		PMMA
Lens alignment		side lens
Tightening torque	[Nm]	1; (screws)

Displays / operating elements		
Display	operation	1 x LED, green

Remarks		
Remarks		operating voltage "supply class 2" according to cULus
Pack quantity		1 pcs.

### Electrical connection

Cable: 0.3 m, PUR; 2 x 0.25 mm<sup>2</sup>

Connector: 1 x M12; coding: A



### Connection

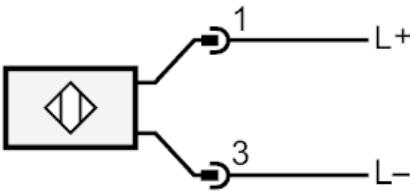



## Through-beam sensor transmitter

O6S-OOKG/0,30m/US

### Diagrams and graphs

excess gain graph

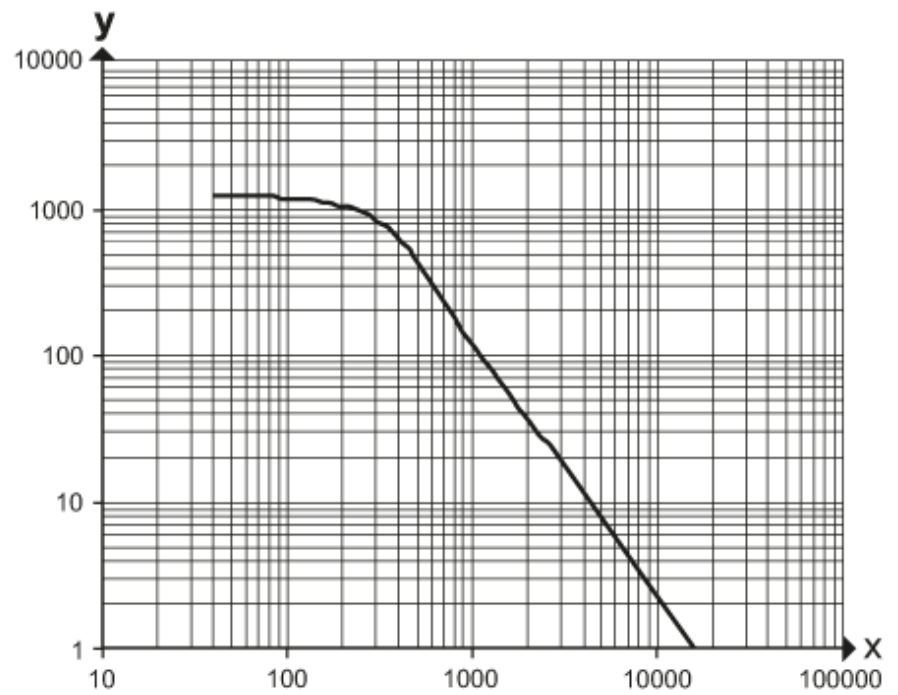

x: distance [mm]

y: excess gain factor