

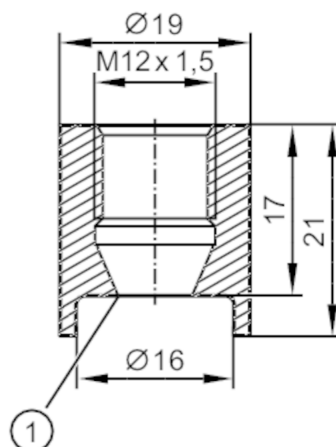

Welding adapter for process sensors

ADAPT M12-WELDING ACCESSORY



1 sealing edge

EC 1935/2004 

Application

Medium temperature	[°C]	< 250
Pressure rating	[bar]	50

Tests / approvals

Pressure Equipment Directive	A possible classification to PED depends on the application and has to be carried out by the user / operator.
Safety instructions	The compatibility between medium and product material has to be checked in all applications.

Mechanical data

Weight	[g]	33.05
Materials		stainless steel (1.4404 / 316L)
Tightening torque	[Nm]	5...20
Sensor connection		M12 x 1,5 sealing cone
Process connection		welding adapter Ø 19 mm

Remarks

Pack quantity	1 pcs.
---------------	--------