

## Mounting set for reflectors

SYSTEM COMPONENT REFL BOLT

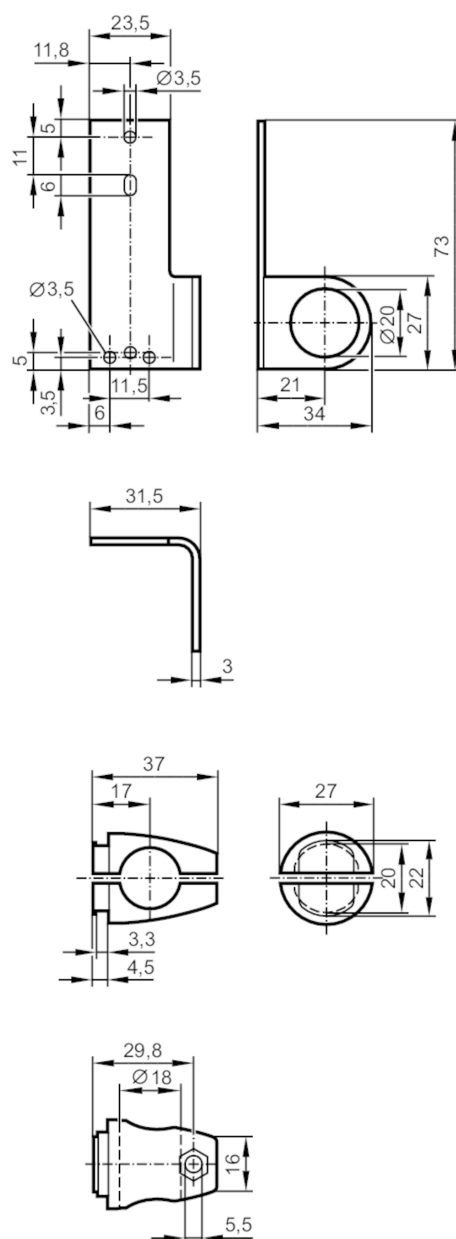

## Application

Design

clamp mounting, for reflector, 72,5 x 19 mm

## Mechanical data

Weight

[g]

121.5

Type of mounting

Mounting rod; ( $\varnothing 18$  mm)

Materials

fixture: stainless steel (1.4571/316Ti ); Clamp: diecast zinc

## Remarks

Pack quantity

1 pcs.