

Mounting adapter for position sensors used on rising stem valves

ADAPTER VALVIS 09

Article no longer available - archive entry

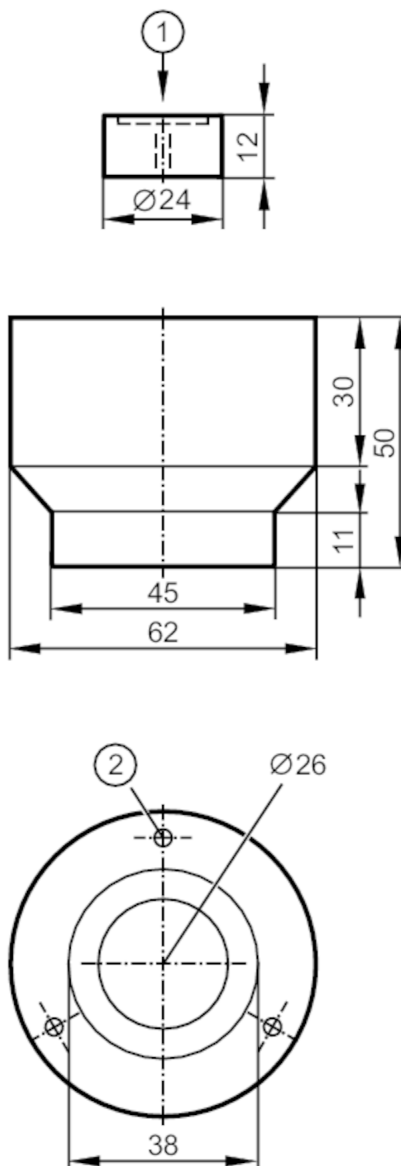

- 1 threaded hole M5 to fix the target on the valve piston
 2 bore hole to fix the valve sensor on the adapter

Application

Design accessories for, for GEMÜ actuators with mounting kit, IX5010, IX5030

Mechanical data

Weight [g] 180

Materials Adapter: POM; Target: stainless steel

Accessories

Items supplied screws: 3, thread forming

Remarks

Pack quantity 1 pcs.