

DN2003



Switched-mode power supply 24 V DC

POWER SUPPLY/24VDC/10A

Article no longer available - archive entry

Alternative articles: DN2013

When selecting an alternative article and accessories please note that technical data may differ!

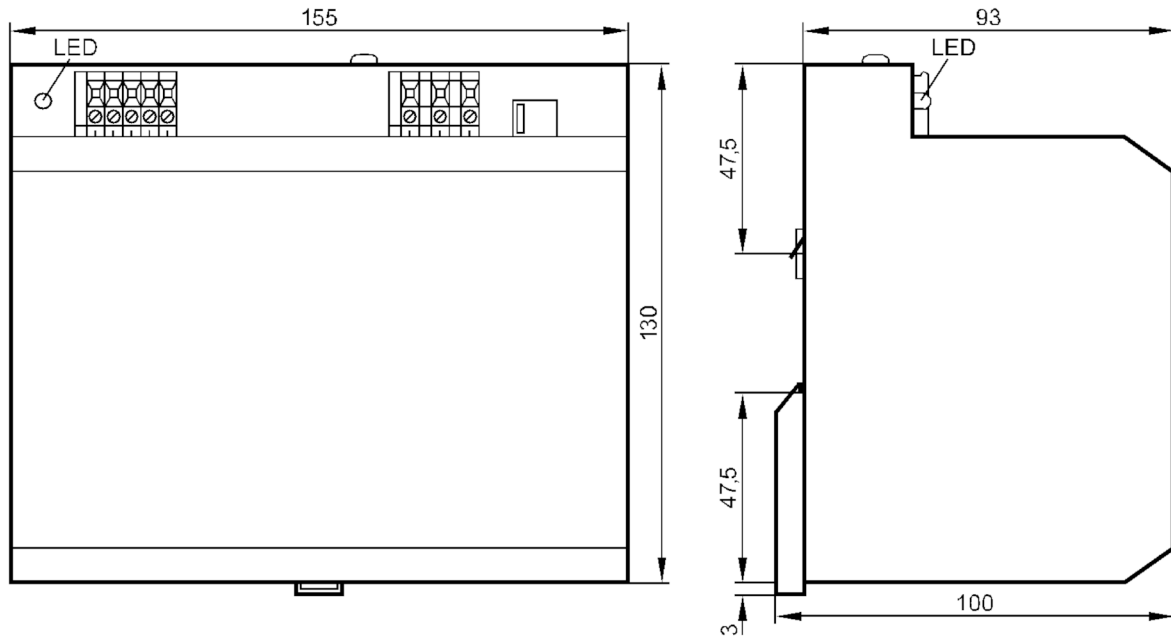

Electrical data

Nominal voltage AC	[V]	< 230
Nominal frequency AC	[Hz]	47...63
Input voltage range AC	[V]	88...132 / 187...264
Protection class		I
Max. power-on delay time	[ms]	35
Power-on delay time	[s]	35
Output voltage tolerance	[%]	2
Max. output current at min. output voltage	[A]	10
Number of output circuits		1
Max. residual ripple	[%]	1
Derating	[W/K]	1 (60...70 °C)

Outputs

Short-circuit protection	yes
Overload protection	yes

Operating conditions

Ambient temperature	[°C]	0...60
Protection		IP 20

DN2003



Switched-mode power supply 24 V DC

POWER SUPPLY/24VDC/10A

Mechanical data		
Materials	aluminium	
Displays / operating elements		
Display	function	LED, green
Remarks		
Pack quantity	1 pcs.	
Electrical connection		
terminals: ...2.5 mm ²		

Connection

