

AC1012



AS-Interface PLC

Contr 2MSTR 1RS232C 1RS485

Article no longer available - archive entry

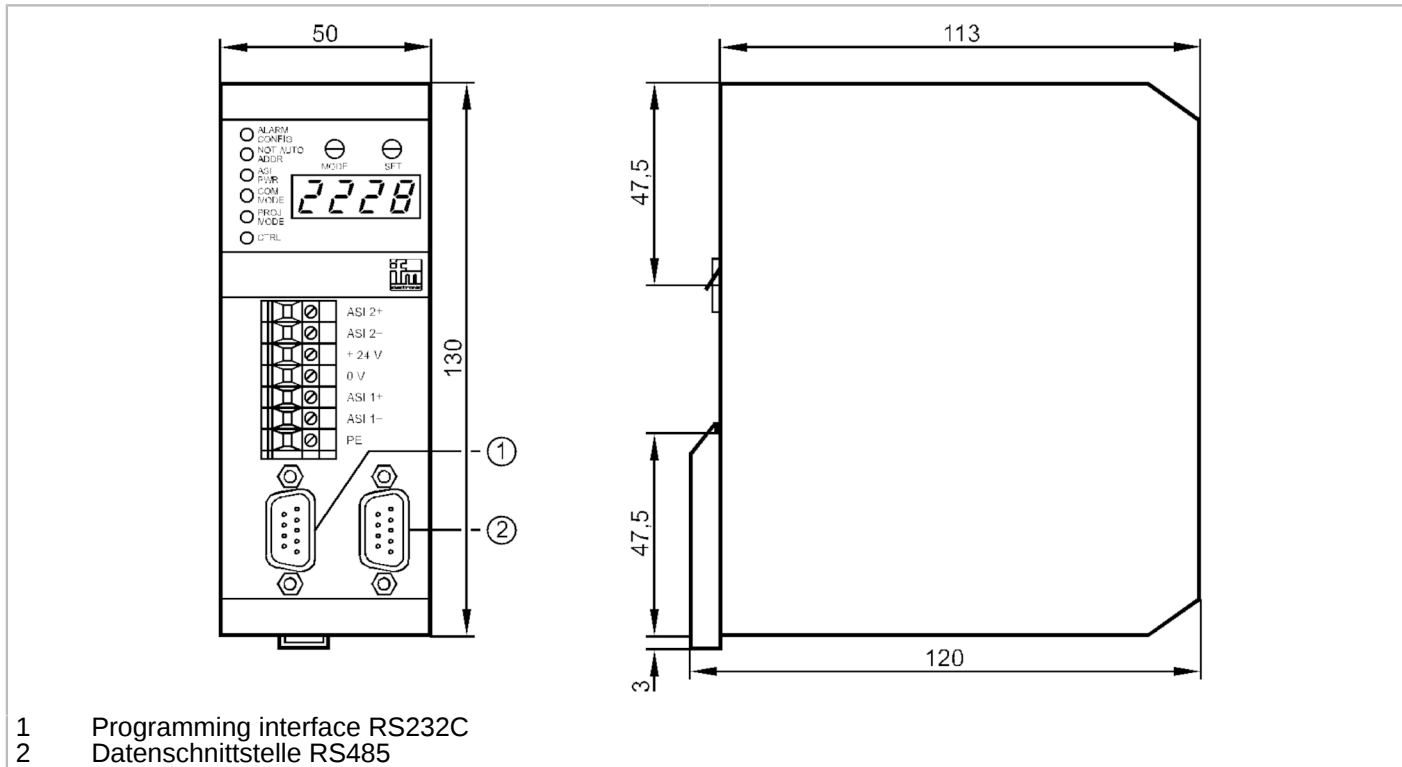

Application	
Application	mini-controller for signal preprocessing
Electrical data	
Operating voltage [V]	22...30 DC; (24 DC; to PELV)
Insulation rating [V]	500
Max. current consumption from AS-i [mA]	80
Electrical separation	yes
Outputs	
Electrical design	AS-i
Interfaces	
Communication interface	RS232
RS232	
Number of R232 interfaces	1
Transmission rate	4800...62400 Baud
Connector type	SUB-D
Usage type	programming
Operating conditions	
Ambient temperature [°C]	0...60
Storage temperature [°C]	-20...70
Protection	IP 20

AC1012



AS-Interface PLC

Contr 2MSTR 1RS232C 1RS485

Tests / approvals		
Shock/vibration resistance	< 15 g (11ms) / < 55 Hz (0.5mm)	
AS-i classification		
AS-i profile	M1	
AS-i certificate	22505	
Mechanical data		
Housing	housing for DIN rail mounting	
Materials	aluminium	
Displays / operating elements		
Display	function check	2 x LED, red
		2 x LED, green
		2 x LED, yellow
Remarks		
Pack quantity	1 pcs.	
Electrical connection		
screw terminals: 7 x		
Connection		

7	AS-i 2+
6	AS-i 2-
5	+ 24 V
4	0 V
3	AS-i 1+
2	AS-i 1-
1	PE