

AC1005



AS-Interface PROFIBUS DP gateway with PLC

Contr 1MSTR 1RS232C 1DP

Article no longer available - archive entry

Alternative articles: AC1027

When selecting an alternative article and accessories please note that technical data may differ!

Replacement units for Krones systems should be obtained directly from the company Krones.

This unit is not directly compatible.

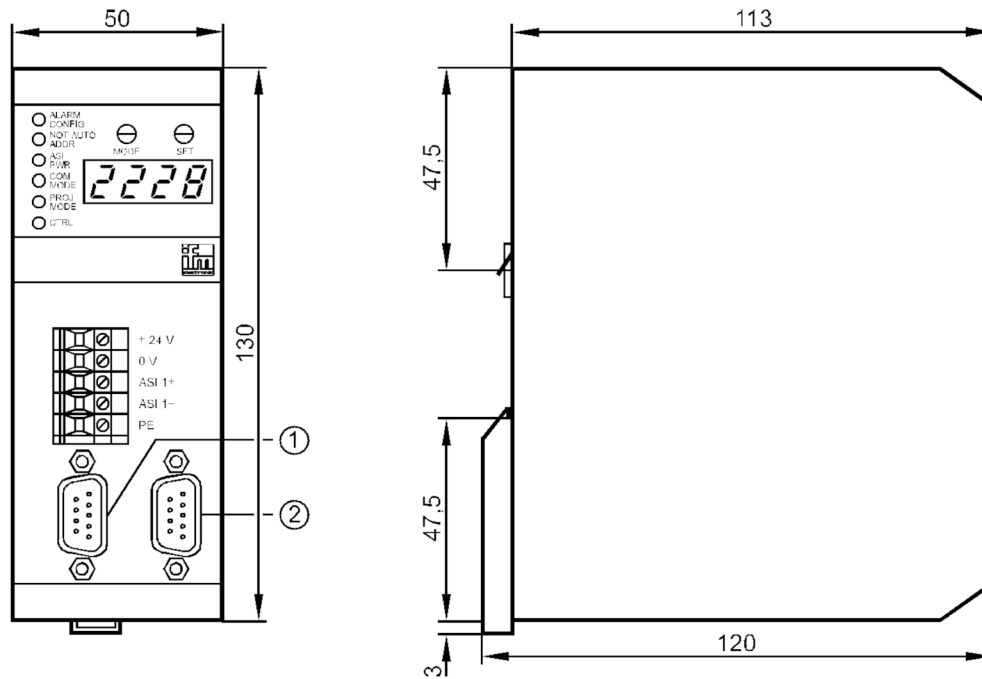

- 1 serial interface RS232C
- 2 PROFIBUS DP interface



Application

Application use as minicontroller and gateway

Electrical data

| | |
|---|------------------------------|
| Operating voltage [V] | 22...30 DC; (24 DC; to PELV) |
| Insulation rating [V] | 500 |
| Max. current consumption from AS-i [mA] | 80 |
| Max. power consumption [VA] | 10 |
| Electrical separation | yes |

Outputs

Electrical design AS-i

Interfaces

Communication interface RS232

AC1005



AS-Interface PROFIBUS DP gateway with PLC

Contr 1MSTR 1RS232C 1DP

| | |
|---------------------------|-------------------|
| RS232 | |
| Number of R232 interfaces | 1 |
| Transmission rate | 4800...62400 Baud |
| Connector type | SUB-D |
| Usage type | programming |

| | |
|--------------------------------|----------|
| Operating conditions | |
| Ambient temperature [°C] | 0...60 |
| Storage temperature [°C] | -20...70 |
| Max. relative air humidity [%] | 95 |
| Protection | IP 20 |

| | |
|----------------------------|-------|
| AS-i classification | |
| AS-i profile | M1 |
| AS-i certificate | 22501 |

| | |
|------------------------|-------------------------------|
| Mechanical data | |
| Housing | housing for DIN rail mounting |
| Materials | aluminium |

| | | |
|--------------------------------------|----------------|-----------------|
| Displays / operating elements | | |
| Display | function check | 2 x LED, red |
| | | 2 x LED, green |
| | | 2 x LED, yellow |

| | |
|----------------|--|
| Remarks | |
| Remarks | Replacement units for Krones systems should be obtained directly from the company Krones. This unit is not directly compatible. |
| Notes | Replacement units for Krones systems should be obtained directly from the company Krones.; This unit is not directly compatible. |
| Pack quantity | 1 pcs. |

Electrical connection

screw terminals: 5 x

Connection

