

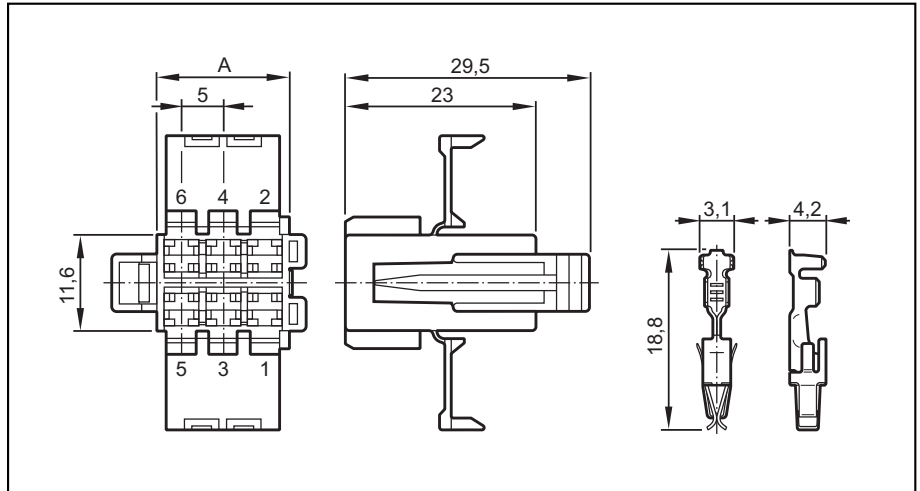

EC2089

Steckersatz
für
CabinetModule
CR2016
konfektionierbar



Technische Daten

**AMP Crimp-Buchsengehäuse
inkl. Crimp-Kontakte (Junior Power Timer)**

Lieferumfang

Gehäuse

Kontakte

Schutzart

Material (Gehäuse)

Material (Crimp-Kontakte)

1 x 6-polig, 2 x 14-polig, 2 x 18-polig
75

IP 20

PBT (schwarz)

CuSn (verzinnt)

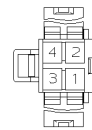

A = 11

4-polig

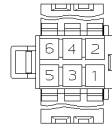

A = 16

6-polig

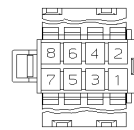

A = 21

8-polig

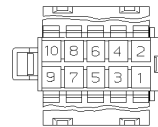

A = 26

10-polig

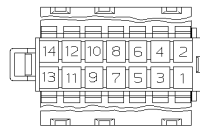

A = 36

14-polig

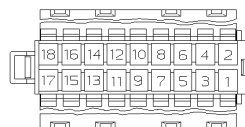

A = 46

18-polig

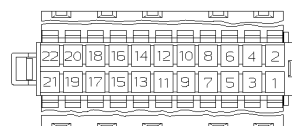

A = 56

22-polig



EC2089

Plug set
for
CabinetModule
CR2016
wirable

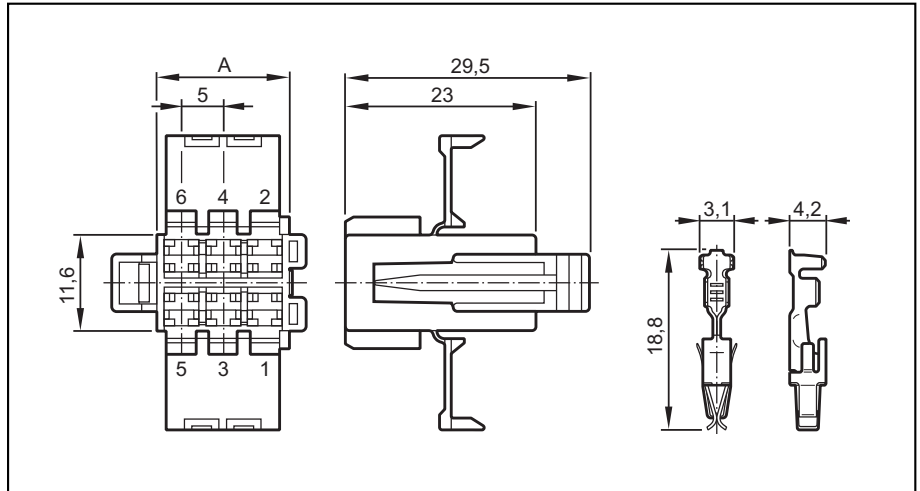

Technical data

Components
housing
contacts

Protection

Material (housing)

Material (contacts)

**AMP Crimp housing
incl. Crimp contacts (Junior Power Timer)**

1 x 6 pins, 2 x 14 pins, 2 x 18 pins
75

IP 20

PBT (black)

CuSn (tin plated)

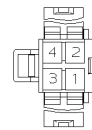

A = 11

4 pins

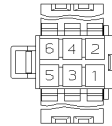

A = 16

6 pins

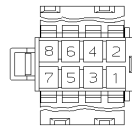

A = 21

8 pins

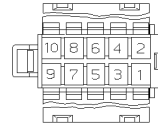

A = 26

10 pins

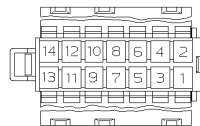

A = 36

14 pins

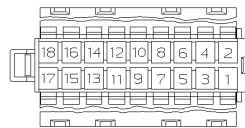

A = 46

18 pins

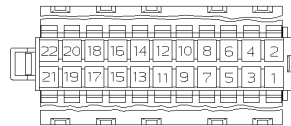

A = 56

22 pins