

## Flow sensor for connection to an evaluation unit

SFR12ABH

Article no longer available - archive entry

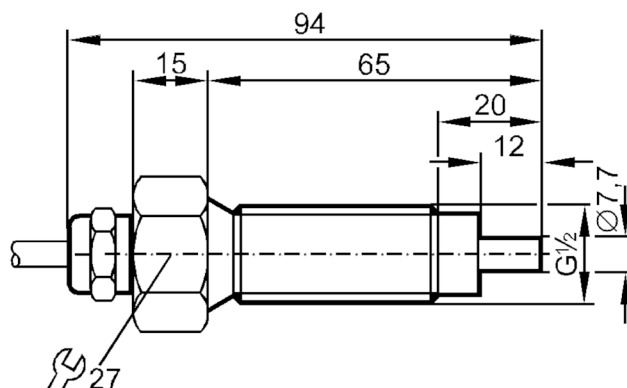

## Product characteristics

Process connection	G 1/2 external thread
--------------------	-----------------------

## Application

Application	high-temperature range
Media	Liquids; Gases
Medium temperature [°C]	-25...80
Pressure rating [bar]	30

## Liquids

Application	high-temperature range
Medium temperature [°C]	-25...80

## Gases

Medium temperature [°C]	-25...80
-------------------------	----------

## Electrical data

Connection to control monitor	VS 0200
-------------------------------	---------

## Measuring/setting range

## Liquids

Setting range [cm/s]	3...300
Greatest sensitivity [cm/s]	3...60

## Gases

Setting range [cm/s]	100...2000
Greatest sensitivity [cm/s]	100...800

## Accuracy / deviations

Temperature gradient [K/min]	15
------------------------------	----



## Flow sensor for connection to an evaluation unit

SFR12ABH

Response times	
Response time [s]	2...10
Liquids	
Response time [s]	2...10
Gases	
Response time [s]	2...10
Operating conditions	
Protection	IP 67
Mechanical data	
Housing	threaded type
Materials	Hastelloy C-22 (2.4602)
Materials (wetted parts)	Hastelloy C-22 (2.4602)
Process connection	G 1/2 external thread
Accessories	
Items supplied	sealings: 2 x AMF 30
Remarks	
Pack quantity	1 pcs.
Electrical connection	
Cable: 2 m, PUR; Maximum cable length: 100 m; 5 x 0.34 mm <sup>2</sup>	
Connection	

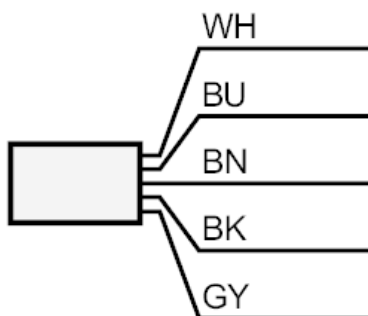

Core colours :

BK = black

BN = brown

BU = blue

WH = white

GY = grey