

E43309

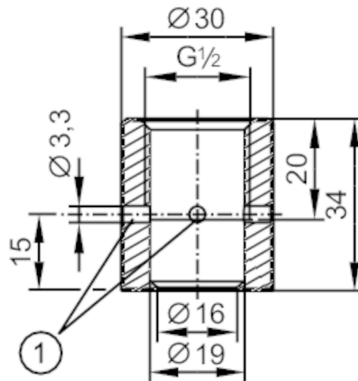

Welding adapter for process sensors

ADAPT G1/2-WELD SLEEVE 3A



1 Leakage port



CRN EC 1935/2004 EHEDG Certified FCM FDA

Application	
Design	for tanks, with leakage port
Pressure rating [bar]	50
Note on pressure rating	for the connection sensor - adapter
MAWP (for applications according to CRN) [bar]	50
Tests / approvals	
Pressure Equipment Directive	A possible classification to PED depends on the application and has to be carried out by the user / operator.
Pressure Equipment Directive EAC	The adapter is intended for use in devices, machines and installations that do not fall under the categories of the technical rule TR CU 032/2013.
Safety instructions	The compatibility between medium and product material has to be checked in all applications.
Mechanical data	
Weight [g]	167
Materials	stainless steel (1.4435 / 316L)
Sensor connection	G 1/2 sealing cone
Process connection	welding adapter Ø 30 mm
Surface characteristics Ra/Rz of the wetted parts	0.4 / 4
Accessories	
Items supplied	O-rings:, FKM
Remarks	
Pack quantity	1 pcs.