

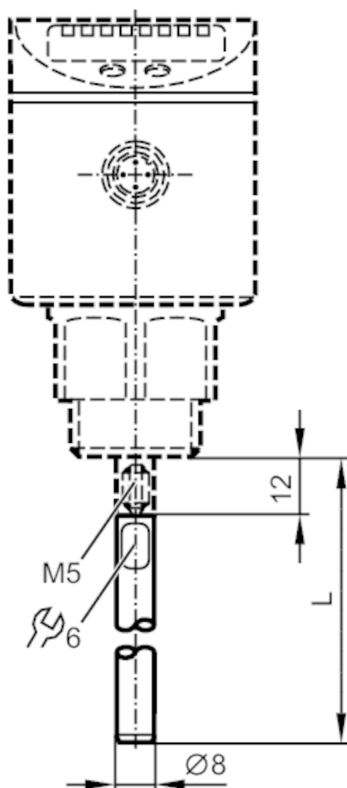

Probe for level sensors

LR PROBE L450



Application

Design	for level sensors LR
--------	----------------------

Measuring/setting range

Probe length L	[mm]	450
----------------	------	-----

Mechanical data

Weight	[g]	194.2
Materials	stainless steel (316L/1.4404)	
Tightening torque	[Nm]	4

Remarks

Pack quantity	1 pcs.
---------------	--------