

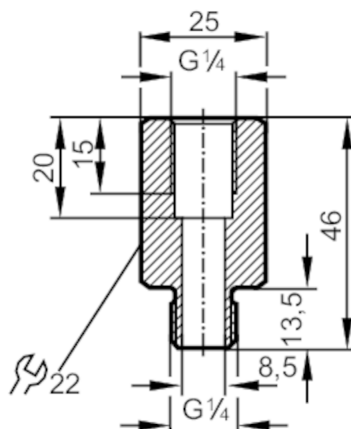

Screw-in adapter for process sensors

ADAPT TA G1/4 V4A



Application

Pressure rating	[bar]	400
-----------------	-------	-----

Tests / approvals

Pressure Equipment Directive	A possible classification to PED depends on the application and has to be carried out by the user / operator.
------------------------------	---

Safety instructions	The compatibility between medium and product material has to be checked in all applications.
---------------------	--

Mechanical data

Weight	[g]	91.3
Materials		stainless steel (316L/1.4404)
Sensor connection		G 1/4
Process connection		threaded connection G 1/4

Remarks

Pack quantity	1 pcs.
---------------	--------