

## Through-beam sensor transmitter

O6S-00KG/AS/4P

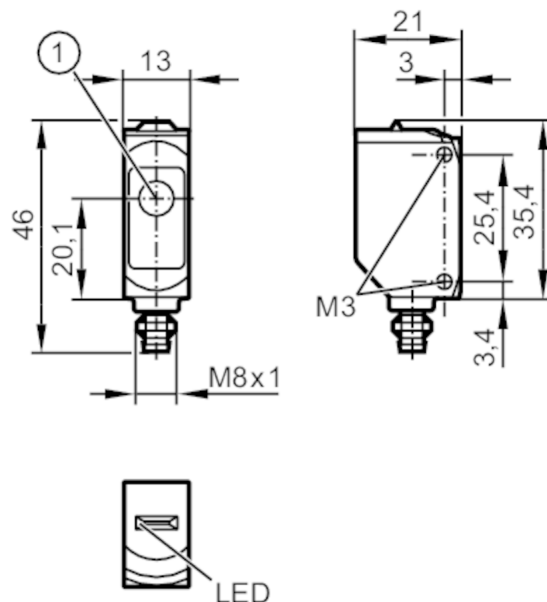

1: light emission



## Product characteristics

|               |             |
|---------------|-------------|
| Type of light | red light   |
| Housing       | rectangular |

## Application

|                    |                     |
|--------------------|---------------------|
| Function principle | Through-beam sensor |
|--------------------|---------------------|

## Electrical data

|                     |      |              |
|---------------------|------|--------------|
| Operating voltage   | [V]  | 10...30 DC   |
| Current consumption | [mA] | 11; ((24 V)) |
| Protection class    |      | III          |
| Type of light       |      | red light    |
| Wave length         | [nm] | 633          |

## Detection zone

|                                |      |                  |
|--------------------------------|------|------------------|
| Transmitter / receiver         |      | transmitter      |
| Range                          | [m]  | < 10             |
| Max. light spot diameter       | [mm] | 300              |
| Light spot dimensions refer to |      | at maximum range |

## Operating conditions

|                     |      |              |
|---------------------|------|--------------|
| Ambient temperature | [°C] | -25...60     |
| Protection          |      | IP 65; IP 67 |

## Tests / approvals

|             |         |                      |
|-------------|---------|----------------------|
| EMC         |         | EN 60947-5-2         |
| MTTF        | [years] | 2600                 |
| UL approval |         | UL Approval no. E002 |



Through-beam sensor transmitter

O6S-00KG/AS/4P

| Mechanical data   |      |                    |
|-------------------|------|--------------------|
| Weight            | [g]  | 17.6               |
| Housing           |      | rectangular        |
| Dimensions        | [mm] | 35.4 x 13 x 21     |
| Materials         |      | housing: ABS; PPSU |
| Lens material     |      | PMMA               |
| Lens alignment    |      | side lens          |
| Sealing material  |      | EPDM               |
| Tightening torque | [Nm] | 0.5                |

| Displays / operating elements |           |                |
|-------------------------------|-----------|----------------|
| Display                       | operation | 1 x LED, green |

| Remarks       |  |   |
|---------------|--|---|
| Remarks       |  | operating voltage "supply class 2" according to cULus |
| Pack quantity |  | 1 pcs.  |

Electrical connection

Connector: 1 x M8; coding: A; Locking: brass, coated; Sealing: EPDM



Connection

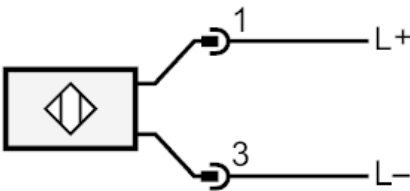



## Through-beam sensor transmitter

O6S-OOKG/AS/4P

### Diagrams and graphs

excess gain graph

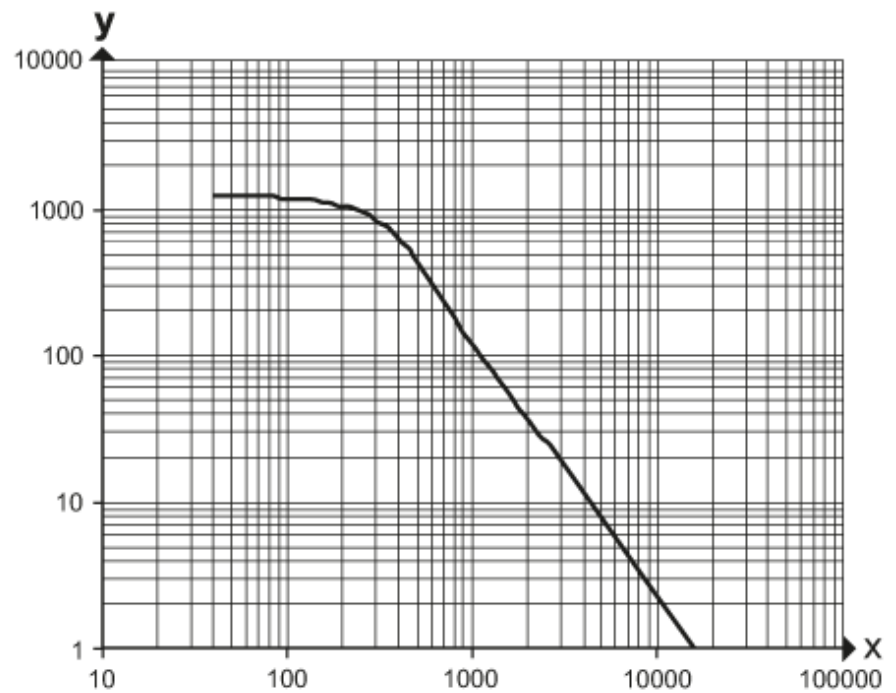

x: distance [mm]

y: excess gain factor