

# RB6027



## Incremental encoder with solid shaft

RB-0030-I24/L6

Article no longer available - archive entry

Alternative article: RB6004 When selecting an alternative article and accessories please note that technical data may differ! – When selecting an alternative article and accessories please note that technical data may differ!

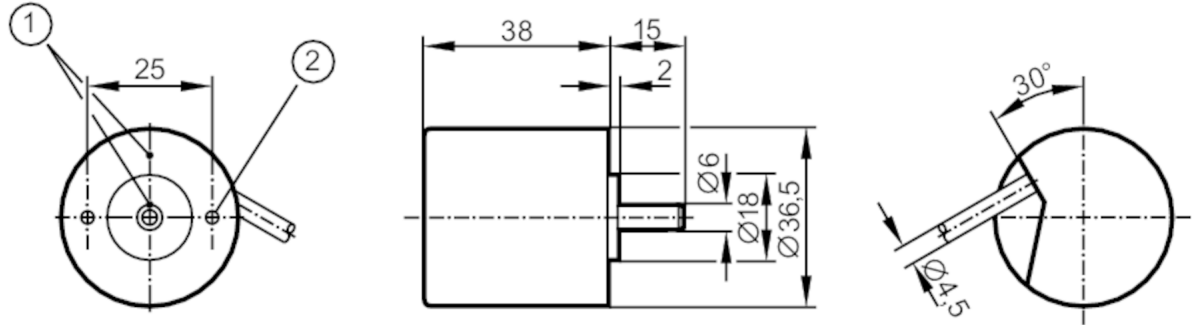

- 1 reference mark
- 2 M3 Depth 5 mm



Product characteristics	
Resolution	30 resolution
Shaft design	solid shaft
Shaft diameter [mm]	6
Electrical data	
Operating voltage [V]	10...30 DC
Current consumption [mA]	150
Outputs	
Electrical design	HTL
Max. current load per output [mA]	50
Switching frequency [kHz]	160
Type of short-circuit protection	< 60 s
Phase difference A and B [°]	90
Measuring/setting range	
Resolution	30 resolution
Operating conditions	
Ambient temperature [°C]	-20...70
Storage temperature [°C]	-30...100
Max. relative air humidity [%]	98
Protection	IP 64
Tests / approvals	
Shock resistance	100 g (6 ms)
Vibration resistance	10 g (55...2000 Hz)

# RB6027



## Incremental encoder with solid shaft

RB-0030-I24/L6

Mechanical data		
Dimensions	[mm]	Ø 36.5 / L = 38
Materials		aluminium
Max. revolution, mechanical	[U/min]	10000
Max. starting torque	[Nm]	1
Reference temperature torque	[°C]	20
Shaft design		solid shaft
Shaft diameter	[mm]	6
Shaft material		steel (1.4104)
Max. shaft load axial (at the shaft end)	[N]	5
Max. shaft load radial (at the shaft end)	[N]	10

### Electrical connection

Cable: 6 m, PUR; radial, can also be used axially

white/green	0V
brown/green	L+
brown	A
green	0V A
grey	B
pink	0V B
red	0 index
black	0V 0 index
lilac	failure inverted
screen	housing

### Diagrams and graphs

Pulse diagram

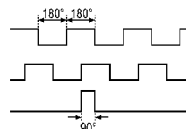

Output A  
Output B  
0 index

Article no longer available - archive entry

Alternative article: RB6004 When selecting an alternative article and accessories please note that technical data may differ! – When selecting an alternative article and accessories please note that technical data may differ!