

## Through-beam sensor transmitter

OGS-00KG/US100

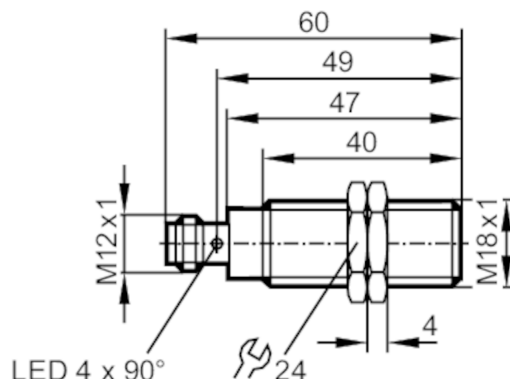

### Product characteristics

Type of light	red light
Housing	threaded type

### Application

Function principle	Through-beam sensor
--------------------	---------------------

### Electrical data

Operating voltage [V]	10...36 DC
Current consumption [mA]	15
Protection class	II
Reverse polarity protection	yes
Type of light	red light
Wave length [nm]	624

### Detection zone

Transmitter / receiver	transmitter
Range [m]	< 20
Range adjustable	no
Max. light spot diameter [mm]	800
Light spot dimensions refer to	at maximum range

### Operating conditions

Ambient temperature [°C]	-25...60
Protection	IP 67

### Tests / approvals

EMC	EN 60947-5-2
MTTF [years]	755

### Mechanical data

Weight [g]	49.1
Housing	threaded type
Dimensions [mm]	M18 x 1 / L = 60
Thread designation	M18 x 1

# OGS200



## Through-beam sensor transmitter

OGS-00KG/US100

Materials	housing: stainless steel (316L/1.4404)	
Lens material	PMMA	
Displays / operating elements		
Display	operation	1 x LED, green
Accessories		
Items supplied	lock nuts: 2	
Remarks		
Remarks	operating voltage "supply class 2" according to cULus	
Pack quantity	1 pcs.	

### Electrical connection

Connector: 1 x M12; coding: A



### Connection

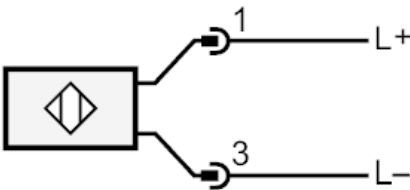



## Through-beam sensor transmitter

OGS-00KG/US100

### Diagrams and graphs

excess gain graph

