

# O8E205

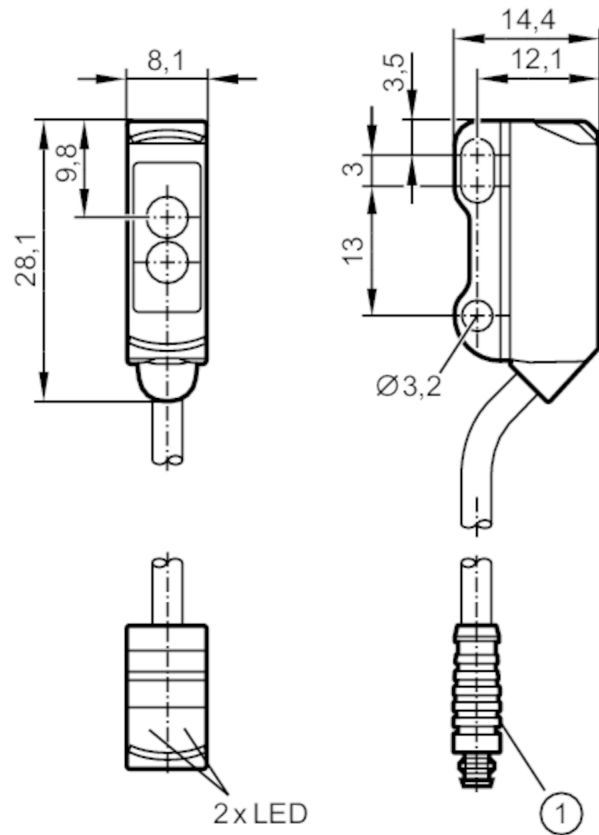

## Through-beam sensor receiver

O8E-DNKG/0,30M/AS/4P



1 receiver in upper lens  
illustration (example)



### Product characteristics

Type of light	red light
Housing	rectangular

### Application

Function principle	Through-beam sensor
--------------------	---------------------

### Electrical data

Operating voltage	[V]	10...30 DC
Current consumption	[mA]	15; ((24 V))
Protection class		III
Reverse polarity protection		yes
Type of light		red light
Wave length	[nm]	633

### Outputs

Electrical design	NPN
Output function	dark-on mode
Max. voltage drop switching output DC	[V] 2.5



## Through-beam sensor receiver

O8E-DNKG/0,30M/AS/4P

Permanent current rating of switching output DC	[mA]	100
Switching frequency DC	[Hz]	1000
Short-circuit protection		yes
Type of short-circuit protection		pulsed

## Detection zone

Transmitter / receiver		receiver
Range	[m]	< 3

## Operating conditions

Ambient temperature	[°C]	-25...60
Protection		IP 65; IP 67

## Tests / approvals

EMC		EN 60947-5-2
MTTF	[years]	1152
UL approval	Ta	-25...60 °C
	Enclosure type	Type 1
	power supply	Limited Voltage/Current
	UL Approval no.	E015
	File number UL	E174191

## Mechanical data

Weight	[g]	23.1
Housing		rectangular
Dimensions	[mm]	28.1 x 8.1 x 14.4
Materials		housing: ABS; stainless steel (316L/1.4404)
Lens material		PMMA
Lens alignment		side lens

## Displays / operating elements

Display	switching status	1 x LED, yellow
	operation	1 x LED, green

## Remarks

Pack quantity	1 pcs.
---------------	--------

## Electrical connection

Cable: 0.3 m, PVC, black, Ø 2.9 mm; 3 x 0.08 mm<sup>2</sup>

Connector: 1 x M8; coding: A



## Through-beam sensor receiver

O8E-DNKG/0,30M/AS/4P

### Connection

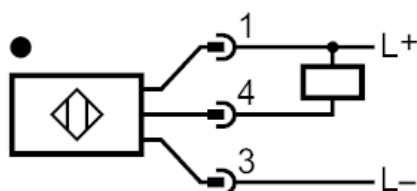

### Diagrams and graphs

excess gain graph

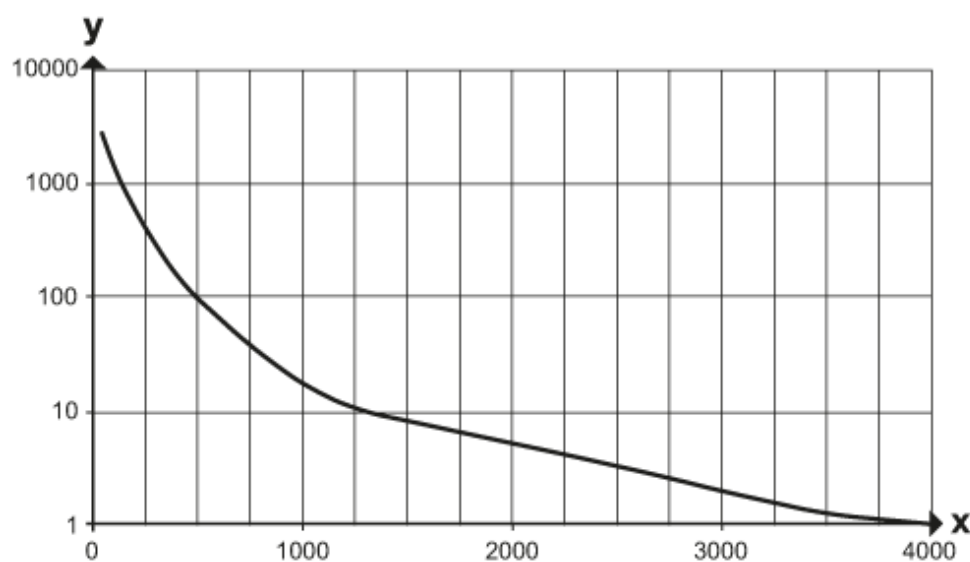

x: distance [mm]

y: excess gain factor