

Clamp fitting for process sensors

MOUNTING ADAPTER NPT1/D22

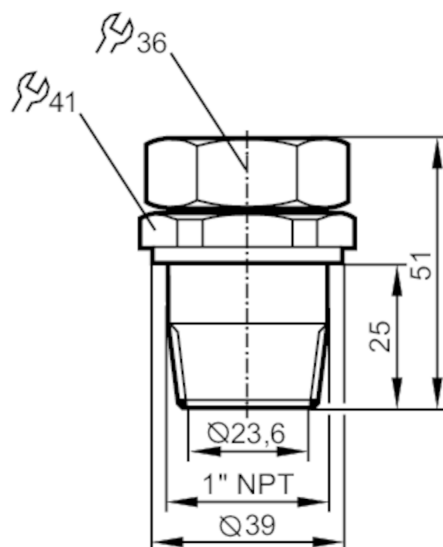

Application

Design	for climatic tube LK, LI
Installation	Clamp fitting
Pressure rating [bar]	0.5

Operating conditions

Ambient temperature [°C]	0...80
--------------------------	--------

Mechanical data

Weight [g]	258.5
Materials	stainless steel; NBR; brass
Tightening torque [Nm]	6...8
Sensor connection	Ø 22 mm
Process connection	threaded connection 1" NPT

Remarks

Pack quantity	1 pcs.
---------------	--------