

# E30131

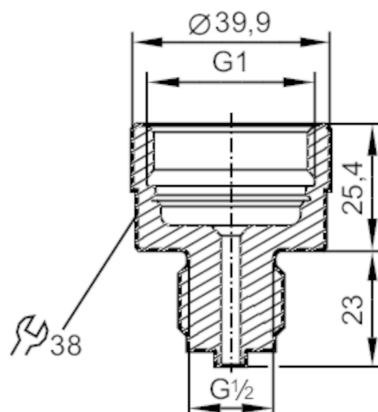

## Screw-in adapter for process sensors

ADAPT G1 / G1/2 A DIN EN 837-3



### ACS Reg31

Application		
Pressure rating	[bar]	100
Tests / approvals		
Pressure Equipment Directive	A possible classification to PED depends on the application and has to be carried out by the user / operator.  The compatibility between medium and product material has to be checked in all applications.	
Safety instructions		
Mechanical data		
Weight	[g]	192
Materials	stainless steel (316L/1.4404)	
Sensor connection	G 1 Aseptoflex Vario	
Process connection	threaded connection G 1/2	
Accessories		
Items supplied	O-rings: 1 x 24 x 2, EPDM, FDA compliant	
Accessories (optional)	O-ring: 1 x 24 x 2, FKM, FDA compliant, E30123	
Remarks		
Pack quantity	1 pcs.	