

# O6S300

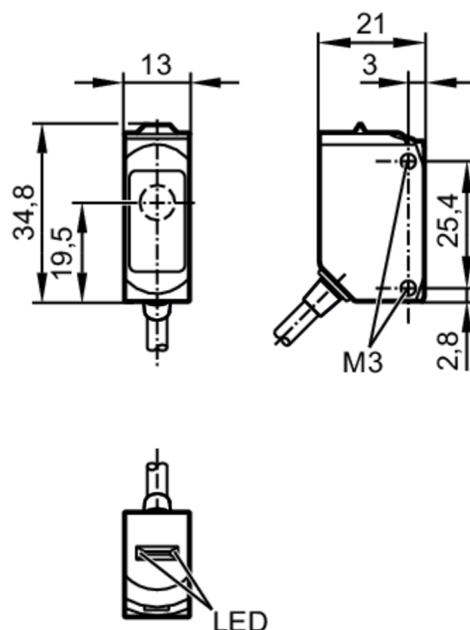

## Through-beam sensor transmitter

O6S-00KG



### Product characteristics

Type of light	red light
Housing	rectangular

### Application

Function principle	Through-beam sensor
--------------------	---------------------

### Electrical data

Operating voltage	[V]	10...30 DC
Current consumption	[mA]	11; ((24 V))
Protection class		III
Type of light		red light
Wave length	[nm]	633

### Detection zone

Transmitter / receiver		transmitter
Range	[m]	< 10
Max. light spot diameter	[mm]	300
Light spot dimensions refer to		at maximum range

### Operating conditions

Ambient temperature	[°C]	-25...80
Protection		IP 65; IP 67; IP 68; IP 69K

### Tests / approvals

EMC		EN 60947-5-2
MTTF	[years]	2600
UL approval		UL Approval no. E004

# O6S300



## Through-beam sensor transmitter

O6S-00KG

Mechanical data		
Weight	[g]	76.4
Housing		rectangular
Materials		housing: stainless steel (316L/1.4404); plastics: PPSU; Sealing: EPDM
Lens material		PMMA
Lens alignment		side lens
Tightening torque	[Nm]	1; (screws)

Displays / operating elements		
Display	operation	1 x LED, green

Remarks		
Remarks		operating voltage "supply class 2" according to cULus
Pack quantity		1 pcs.

### Electrical connection

Cable: 2 m, PVC; 2 x 0.25 mm<sup>2</sup>

### Connection

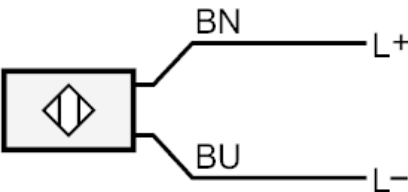

BN = Core colours : brown  
BU = blue

## Through-beam sensor transmitter

O6S-00KG

### Diagrams and graphs

excess gain graph

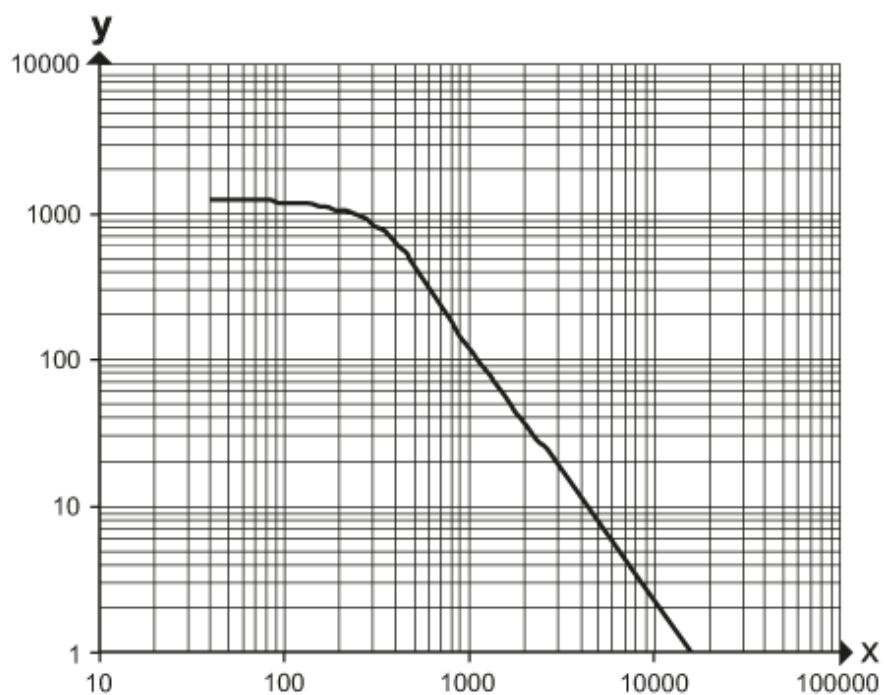

x: distance [mm]

y: excess gain factor