



Position sensors

# Cylinder sensors for robust fixing in C-slots



Cylinder sensors



**Sensor for easy mounting in C-slots**

**Robust fixing at the housing end for strong strain relief**

**Connection and switching output variants for any application**

**Electronic GMR measuring cell for a long sensor life**

**Now also available as 2-wire version for PNP or NPN PLC's**

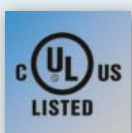

## Flush in the C-slot

The cylinder sensor can be used for the common C-slot such as for SMC. Its height of only 5 mm allows flush mounting. Especially this cylinder manufacturer requires slot-mounting and, often, 2-wire connection.

## Long life

The sensors function without contact and almost without wear. Their life is much longer than that of the common reed contacts.

With the GMR cell (giant magneto resistive), the sensor detects the magnet on the piston through the aluminium wall of the cylinder. This saves expensive repair and downtimes.



Design	Electrical description	Connection	Material	Ambient temperature [°C]	Order no.
--------	------------------------	------------	----------	--------------------------	-----------

### Cylinder sensor C-slot

	2-wire, PNP/NPN	Pigtail 0.3 m, M8 connector	plastic PA (polyamide)	-25...80	<b>MK5362</b>
	2-wire, PNP/NPN	Pigtail 0.3 m, M12 connector	plastic PA (polyamide)	-25...80	<b>MK5363</b>
	2-wire, PNP/NPN	2 m PUR cable, open end	plastic PA (polyamide)	-25...80	<b>MK5365</b>

### Dimensions

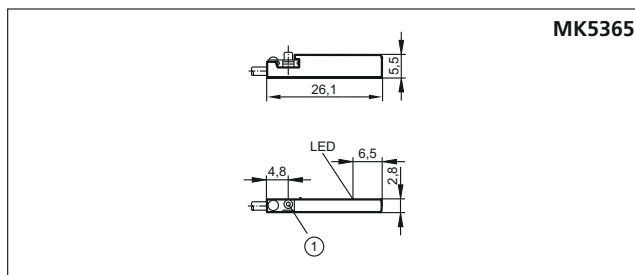
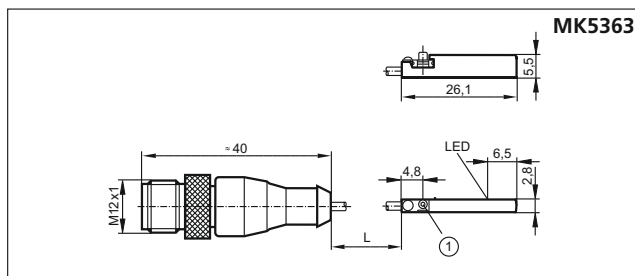
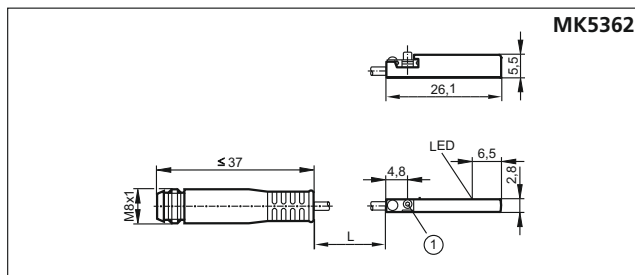

1) Clamping screw

### Wiring diagram

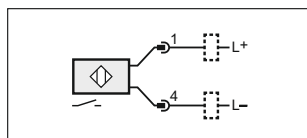

### Further technical data

Operating voltage	[V DC]	10...30
Protection		IP 65 / IP 67
Short-circuit protection		•
Switching frequency	[Hz]	4000
Switching status indication	LED	yellow
UL approval		•

### Accessories

Design	Description	Order no.
	C-slot cylinder memorisation block	<b>E12004</b>
	Switched-mode power supply 24 V DC, 2.5 A	<b>DN1031</b>

### Connection technology

Design	Description	Order no.
	Socket, M12, 4 poles 2 m black, PUR cable	<b>EVC001</b>
	Socket, M8, 4 poles 2 m black, PUR cable	<b>EVC150</b>
	Y splitter, 1 x M12 connector, 5 poles, 2 x M12 socket	<b>EBC117</b>
	Y splitter, 1 x M12 connector, 4 poles, 2 x M12 socket	<b>EBC118</b>