



Position sensors

Feedback for hand valves



Valve sensors, accessories



Suitable for ISO top flange valves from F03 to F16

Easy installation on manual valves and ball valves

Height-adjustable for flexibility

Stainless steel components for long life

Ideal for hazardous areas



End position feedback for manual valves and ball valves

With this mounting kit, you can very easily equip your manual valves with sensors and target pucks. A large number of sensors and pucks can be used on the 80 x 30 mm actuator interface to VDI/VDE 3845. The entire system can be used at ambient temperatures from -30 to +80 °C.







Versatile and flexible

The upper part is made out of Vestamid and allows operation in hazardous areas. The lower part fits on many ISO flange valves (DIN EN ISO 5211) and is connected to the valve shaft by a shaft extension.



Stainless steel components guarantee increased service life.



Accessories

Type	Description	Order no.
	Inductive sensor, PBT, M12 connector	IN5327
	Puck, basic	E12517
	Spacer for ifm puck, PA (required)	E12526
	Plug for covering the oblong holes, EPDM	E12212
	NAMUR sensor (1D, 1G, 2G), M12 connector	NN5008
	Switching amplifiers for Namur sensors, 2 channels	N0532A
	AS-i sensor, M12 connector	AC2315

Connection technology

Type	Description	Order no.
	Socket, M12, 5 m orange, PVC cable	EVT001
	Socket, M12, ATEX approval 5 m, blue, PUR cable	ENC02A

Dimensions

Top flange Ø [mm]	ISO top flange type	Shaft extension	Order no.
36	F03	M4	E12588
42	F04	M5	E12519
50	F05	M4	E12589
50	F05	M5	E12520
50	F05	M6	E12521
70	F07	M6	E12522
70	F07	M8	E12523
102	F10	M8	E12524
125	F12	M10	E12590
140	F14	M10	E12591
165	F16	M10	E12592

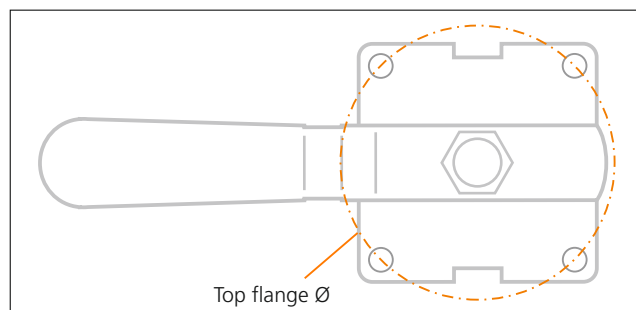

Mounting

