

Through-beam sensor transmitter

OGS-00KG/US100

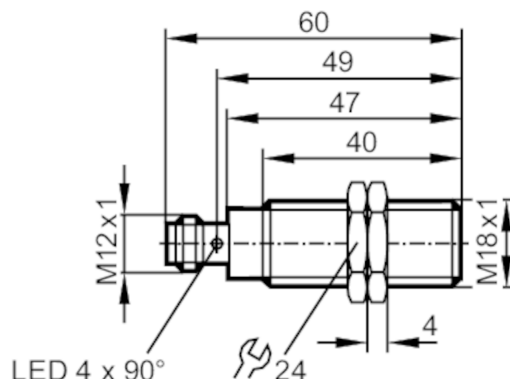

Product characteristics

| | |
|---------------|---------------|
| Type of light | red light |
| Housing | threaded type |

Application

| | |
|--------------------|---------------------|
| Function principle | Through-beam sensor |
|--------------------|---------------------|

Electrical data

| | |
|-----------------------------|------------|
| Operating voltage [V] | 10...36 DC |
| Current consumption [mA] | 15 |
| Protection class | II |
| Reverse polarity protection | yes |
| Type of light | red light |
| Wave length [nm] | 624 |

Detection zone

| | |
|--------------------------------|------------------|
| Transmitter / receiver | transmitter |
| Range [m] | < 20 |
| Range adjustable | no |
| Max. light spot diameter [mm] | 800 |
| Light spot dimensions refer to | at maximum range |

Operating conditions

| | |
|--------------------------|-----------------------------|
| Ambient temperature [°C] | -25...80 |
| Protection | IP 65; IP 67; IP 68; IP 69K |

Tests / approvals

| | |
|--------------|--------------|
| EMC | EN 60947-5-2 |
| MTTF [years] | 755 |

Mechanical data

| | |
|--------------------|------------------|
| Weight [g] | 59.4 |
| Housing | threaded type |
| Dimensions [mm] | M18 x 1 / L = 60 |
| Thread designation | M18 x 1 |

OGS300



Through-beam sensor transmitter

OGS-00KG/US100

| | | |
|---------------|---|--|
| Materials | housing: stainless steel (316L/1.4404); Sealing: EPDM | |
| Lens material | PMMA | |

Displays / operating elements

| | | |
|---------|-----------|----------------|
| Display | operation | 1 x LED, green |
|---------|-----------|----------------|

Accessories

| | |
|----------------|--------------|
| Items supplied | lock nuts: 2 |
|----------------|--------------|

Remarks

| | |
|---------------|---|
| Remarks | operating voltage "supply class 2" according to cULus |
| Pack quantity | 1 pcs. |

Electrical connection

Connector: 1 x M12; coding: A



Connection

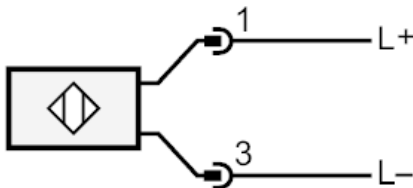



Through-beam sensor transmitter

OGS-00KG/US100

Diagrams and graphs

excess gain graph

