

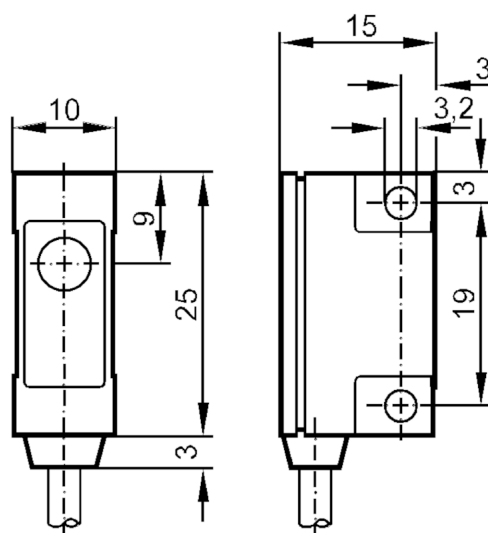

## Through-beam sensor receiver

ORE-V



## Product characteristics

Type of light	infrared light
Housing	rectangular

## Application

Function principle	Through-beam sensor
--------------------	---------------------

## Electrical data

Connection to switching amplifiers	yes
Switching amplifiers	Connection to switching amplifiers OV5012, OV0010
Type of light	infrared light
Wave length [nm]	950

## Outputs

Short-circuit protection	no
Overload protection	no

## Detection zone

Transmitter / receiver	receiver
Range [m]	< 2

## Operating conditions

Ambient temperature [°C]	-20...80
Protection	IP 67

## Tests / approvals

MTTF [years]	49633
--------------	-------



Through-beam sensor receiver

ORE-V

Mechanical data	
Weight	[g] 59
Housing	rectangular
Materials	PPO modified
Lens alignment	side lens
Accessories	
Items supplied	Angle bracket: 1, E20212
Remarks	
Pack quantity	1 pcs.
Electrical connection	
Cable: 2 m; 1 x 0.14 mm²	
Connection	

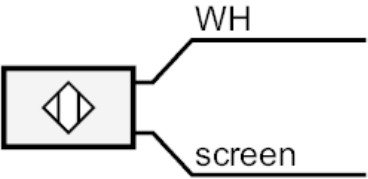

WH = Core colours :  
screen = white  
screen