

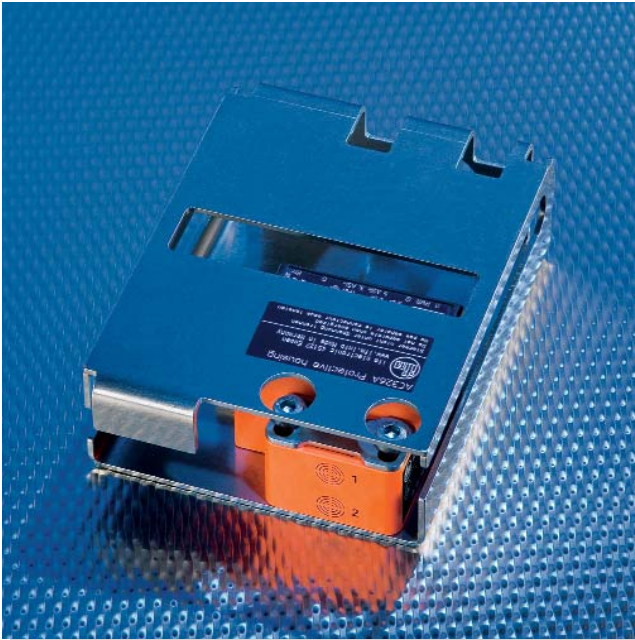

# Feedback for quarterturn actuators to ATEX category 3G.



## Dual sensor with AS-i interface for applications in bioethanol plants.

- Inductive dual sensor for hazardous gas areas, zone 2.
- Installation on actuators to VDI/VDE 3845.
- Solenoid valve connection integrated into the sensor.
- Peripheral fault / communication error indication with wire break monitoring.
- Easy wiring and set-up.



### Applications in hazardous gas areas

The inductive dual sensor meets the requirements of the ATEX category 3G for hazardous zone 2 areas.

### Optimum protection against mechanical stress

The metal housing provides the maximum protection of the sensor and connectors against external mechanical damage. Impact resistance was tested at 4 joules to EN 60079-0: 2006.

### Additional diagnosis

Incidents such as short circuit or wire break can be evaluated separately on the output via two data bits to obtain selected service information.

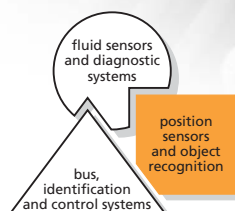
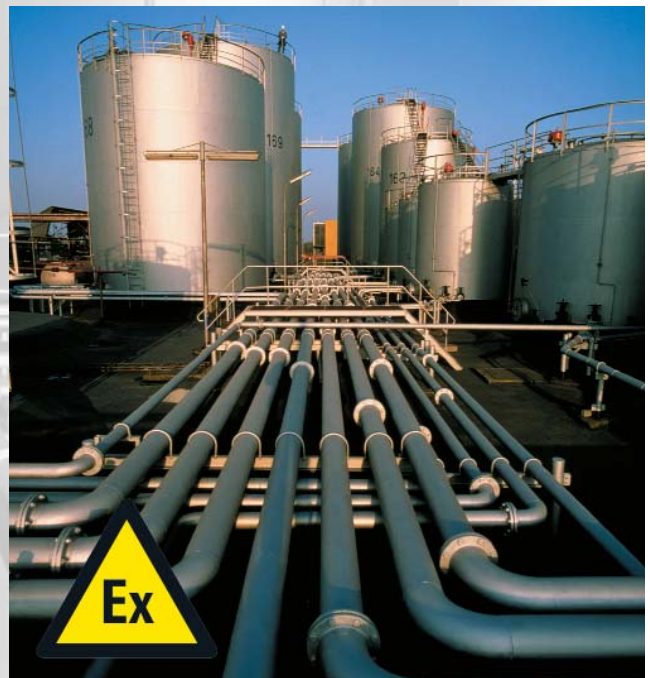



Housing / Dimensions [mm]	Sensing range [mm]	Material	Electrical design	Current consumption [mA]	Current rating [mA]	Order no.
---------------------------	--------------------	----------	-------------------	--------------------------	---------------------	-----------

<b>Category 3G Ex II 3G Ex nA II T6 X</b>						
T5	4 nf	PBT, PC	2 DI, 1 PNP output	< 160	100	AC326A

**Dimensions**

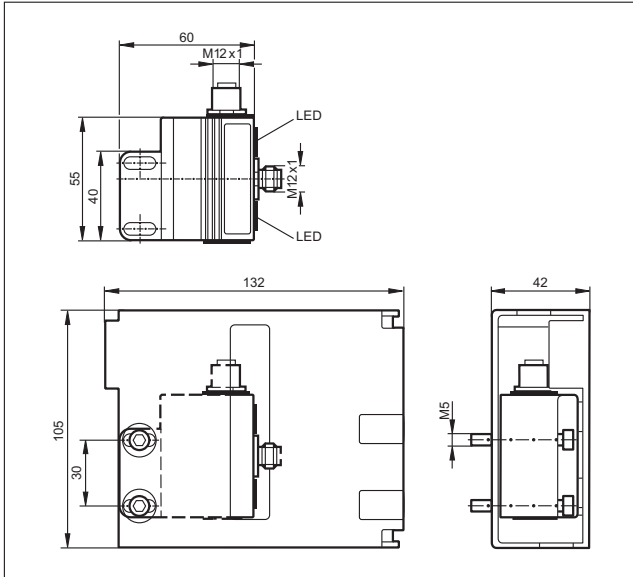

**Common technical data**

Operating temperature	[°C]	-10...50
Indication AS-i voltage	LED	green
Indication peripheral fault	LED	red
Indication communication error	LED	red
Indication switching status	LED	yellow
Protection rating		IP 67
Protective housing		stainless steel
Housing materials		PBT, PC, stainless steel

**Connectors and splitter boxes**

Type	Description	Order no.
	Jumper, M12 / DIN A 0.3 m black, PUR cable	E10817
	Jumper, M12 / DIN B 0.3 m black, PUR cable	E70143
	Jumper, M12 / DIN C 0.3 m black, PUR cable	E10844
	Jumper, M12 plug / M12 socket, 2 m	EVC013
	Jumper, M12 plug / M12 socket, 5 m	EVC014
	Jumper, M12 plug / M12 socket, 2 m	EVC018
	Jumper, M12 plug / M12 socket, 5 m	EVC019

**Accessories**

Type	Description	Order no.
	Target puck, Ø 53 mm	E17320
	Target puck, Ø 65 mm	E17327
	Target puck, Ø 102 mm	E17328
	Addressing unit for version 2.1	AC1144

For a detailed selection tool sorted by valve manufacturers please go to:  
[Http://www.ifm.com/ifmde/web/puck\\_sel.htm](http://www.ifm.com/ifmde/web/puck_sel.htm)

ifm article no. 7511246 · Printed in Germany on non-chlorine paper. · We reserve the right to make technical alterations without prior notice. · 11.2007